

FED. ROAD DIST. NO.	STATE	JOB PIECE NO.	FISCAL YEAR	SHEET NO.	TOTAL SHEETS
6	OKLA.				

DESCRIPTION	REVISIONS	DATE

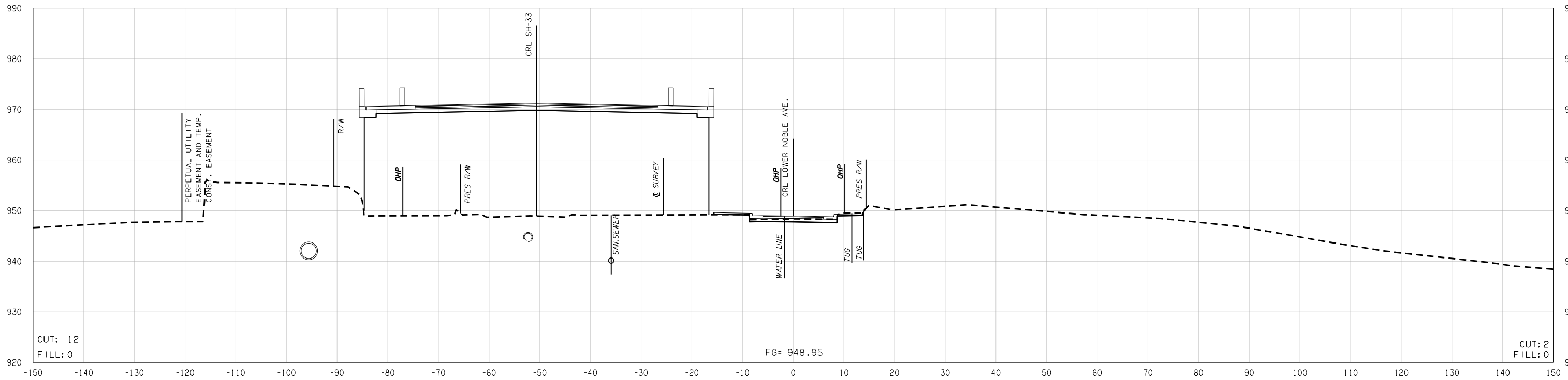

1 + 53.40

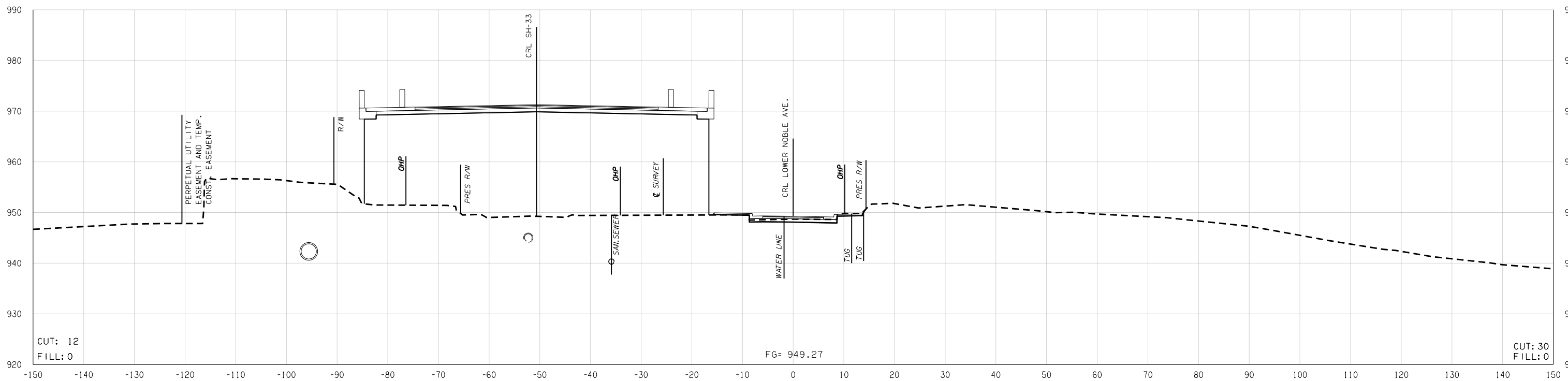

1 + 50.00

Y:\Division 4\21860 (04) \Design\21860\_XSEC\_LowerNobleAve\_2.dgn

08-19-16

STATE JOB NO.	21860(04)
LOGAN COUNTY	SHEET NO. X085

LOWER NOBLE AVE.

SH-33